



GALİPOĞLU®  
**HIDROMAS**

Phone : 90.332 239 08 52 (pbx)

Fax : 90.332 239 08 51

Mail : hidromas@hidromas.com

Address : Büyükkayalık Mah. Konya O.S.B. 3 Nolu Sk No:1/A 42250

SELÇUKLU / KONYA

TÜRKİYE

GHS 197-5-5750 C TEL.SİL.

Product Code :

43197557503

Reference No :

01-001

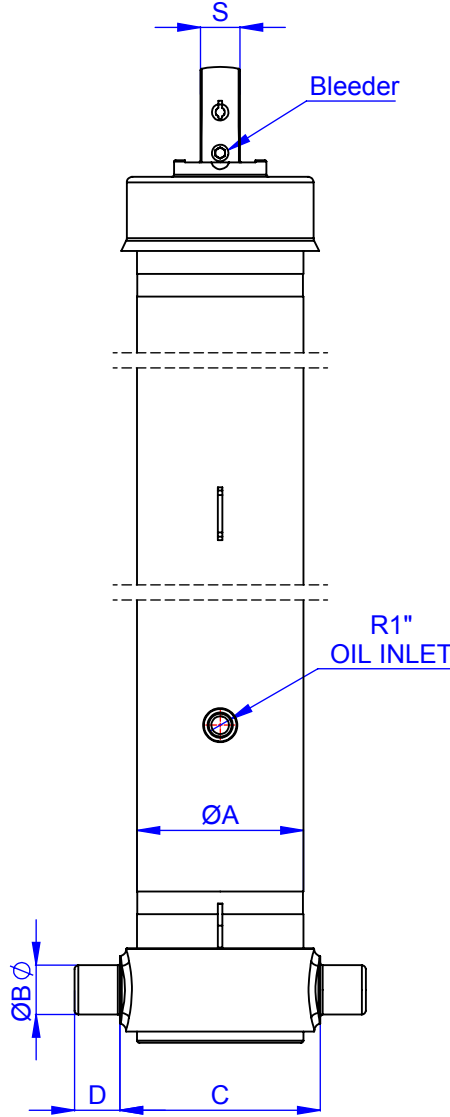
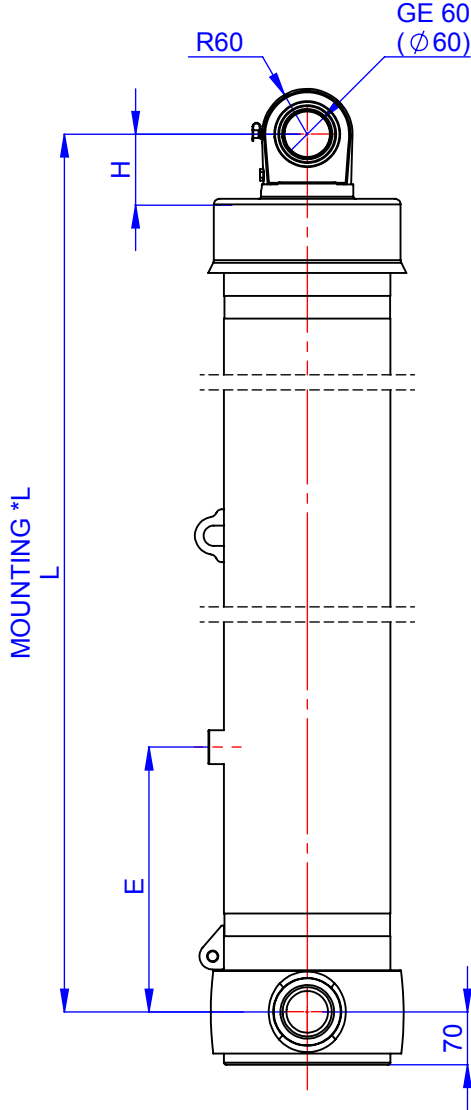

|      |      |
|------|------|
| A :  | 220  |
| B :  | 65   |
| C :  | 265  |
| D :  | 60   |
| E :  | 350  |
| F :  |      |
| G :  |      |
| H :  | 94   |
| I :  |      |
| J :  |      |
| K :  |      |
| L :  | 1439 |
| *L : | 1469 |
| M :  |      |
| N :  |      |
| O :  |      |
| P :  |      |
| R :  |      |
| S :  | 52   |
| S1 : |      |
| T :  |      |
| U :  |      |
| V :  |      |
| W :  |      |
| Y :  |      |
| Z :  |      |

|                          |  |  |      |      |      |      |      |  |  |  |  |
|--------------------------|--|--|------|------|------|------|------|--|--|--|--|
| EFFECTIVE DIAMETER (mm)  |  |  | 197  | 175  | 155  | 135  | 116  |  |  |  |  |
| STROKE (mm)              |  |  | 1150 | 1150 | 1150 | 1150 | 1150 |  |  |  |  |
| THRUST AT 170 BAR (TONS) |  |  | 51.3 | 40.5 | 31.7 | 24.1 | 17.8 |  |  |  |  |

All sizes were given as mm

**SPECIFICATIONS**

- Stroke : 5750
- \*Inc 30 mm pull out : Tolerance +20 ; 0
- Working pressure : 170 Bar
- Max. working pressure : 190 Bar
- Working Temperature : -23 °C / +80 °C
- Total Volume : 132.1 L
- Weight Cylinder : 283.7 kg
- Hard cromed all stages
- All cylinder materials are st 52 cold down tubes
- Standard cylinder is painted with RAL 1036

**FORMULATION**

- St : (Stroke)
- BL : (Body Length)
- Ro : (Rear Overhang)
- PI : (Pivot Length)
- C : (Bracket Length)

$$\alpha^\circ = \frac{St \times 60}{PI}$$

