

15 cc BI-ROTATIONAL GEAR PUMP-ISO
DPA 25-15 ÇİFT DÖNÜŞLÜ DİŞLİ POMPA

Product Code / Ürün Kodu : PDCD250150133
Ref. No : 0002

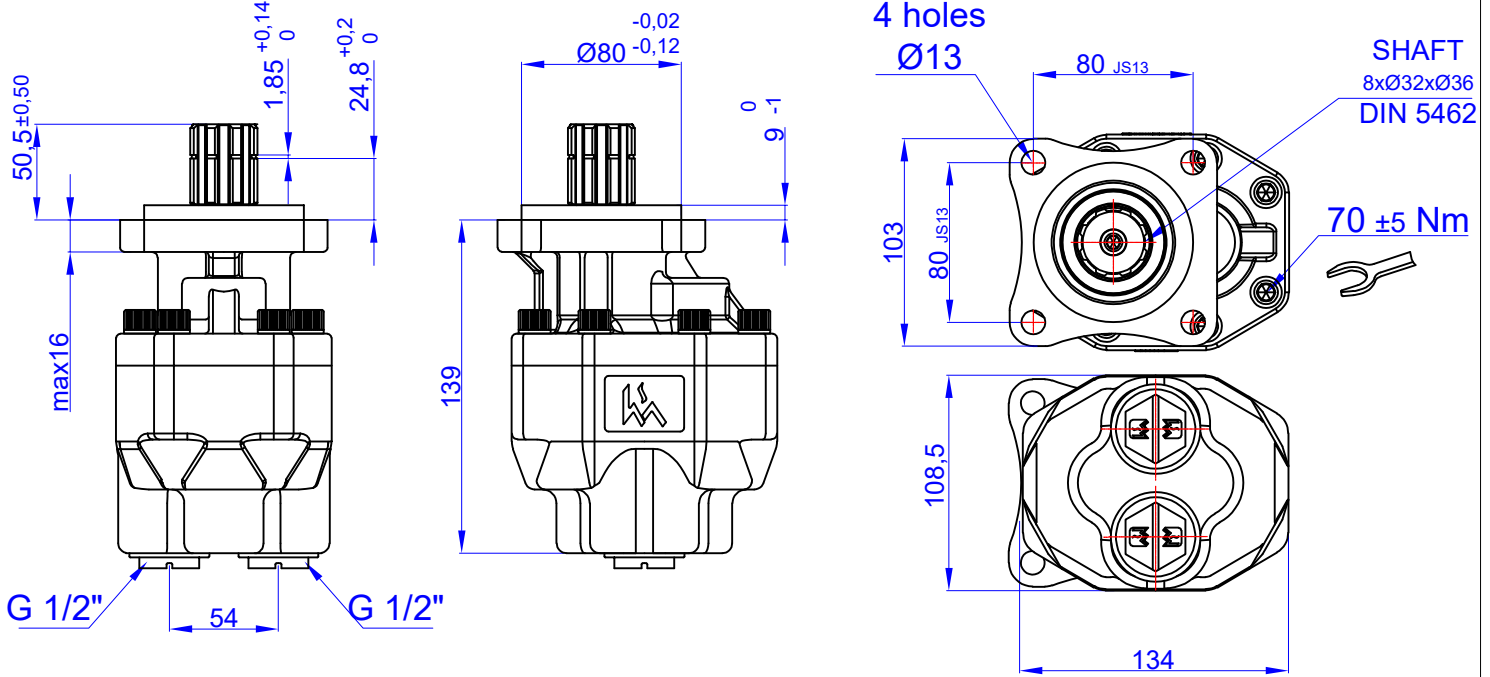

TEKNİK BİLGİLER / TECHNICAL DATA

Specifications	
Displacement	15 cm ³ /rev
Max. Peak Pressure (P3)	290 bar
Max. Intermittent Pressure (P2) (for tipping applications)	270 bar
Max. Continuous Pressure (P1)	240 bar
Max. Speed at Intermittent Press.	2500 min ⁻¹
Min. Speed at Intermittent Press.	400 min ⁻¹
Max. Speed at Continuous Press.	1900 min ⁻¹
Oil Temperature Range	-40 ~ 80 °C
Inlet Pressure Range (suction side)	0,7 ~ 3 bar
Recommended Oil Viscosity Range	12 ~ 100 mm ² /s (cSt)
Max. Starting Viscosity	750 mm ² /s (cSt)
Filtration :	
-Working Pressure < 200 bar	25 µm
-Working Pressure > 200 bar	10 µm
Connection :	
Min. Suction Hose Bore Diameter	- inch
Weight	7,5 kg
Rust prevent oil applied shaft area	protect 12 moths

Power and Torque					
Pressure (Bar)	50	100	200	250	300
Torque (Nm)	13	27	53	66	80

Power (kW)					
rpm / Bar	50	100	200	250	300
500	1	1	3	4	4
1000	1	3	6	7	9
1500	2	4	9	11	13
2000	3	6	11	14	17
2500	4	7	14	18	21

rpm (n/min)	Flow (L/min)
500	7
1000	15
1500	22
2000	29
2500	37

DİYAGRAMLAR / DIAGRAMS

Power-Pressure Graphic

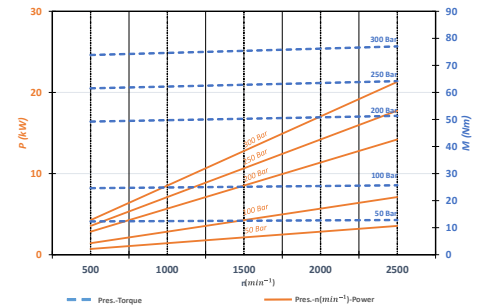

Flow-rpm Graphic

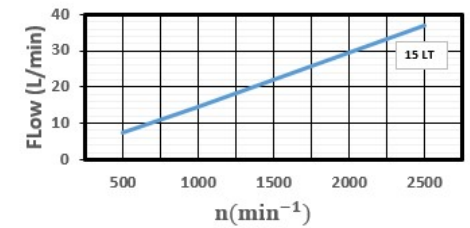

Torque-Pressure Graphic

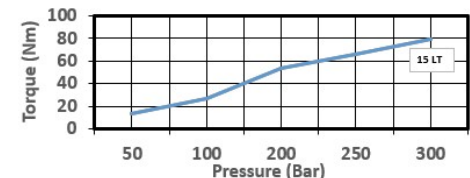

Pressure Definition

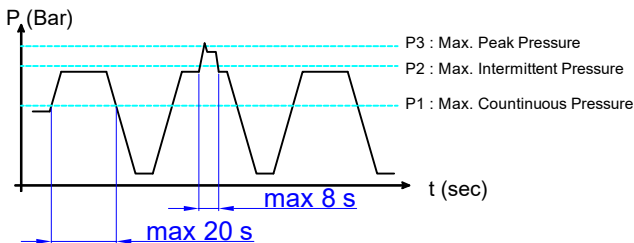

Hydraulic Pump Symbol

