

25 cc BI-ROTATIONAL GEAR PUMP-ISO  
DPA 25-25 ÇİFT DÖNÜŞLÜ DİŞLİ POMPA

Product Code / Ürün Kodu : PDCD250250133  
Ref. No : 0002

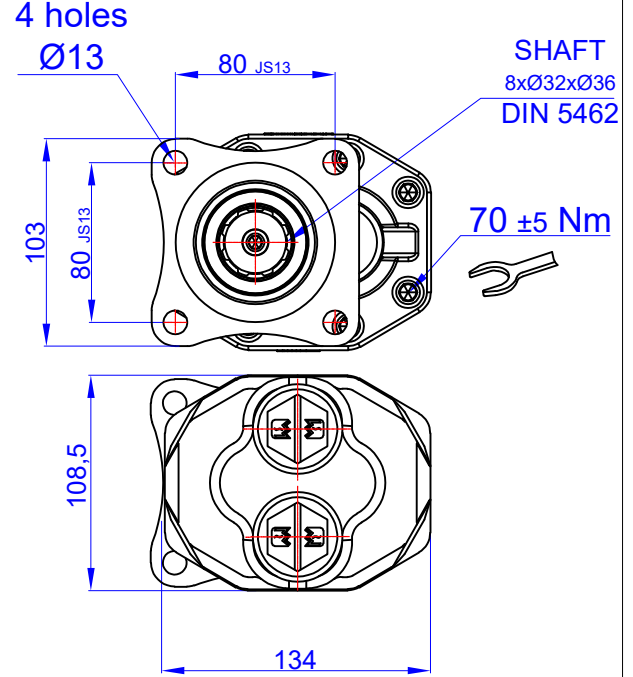
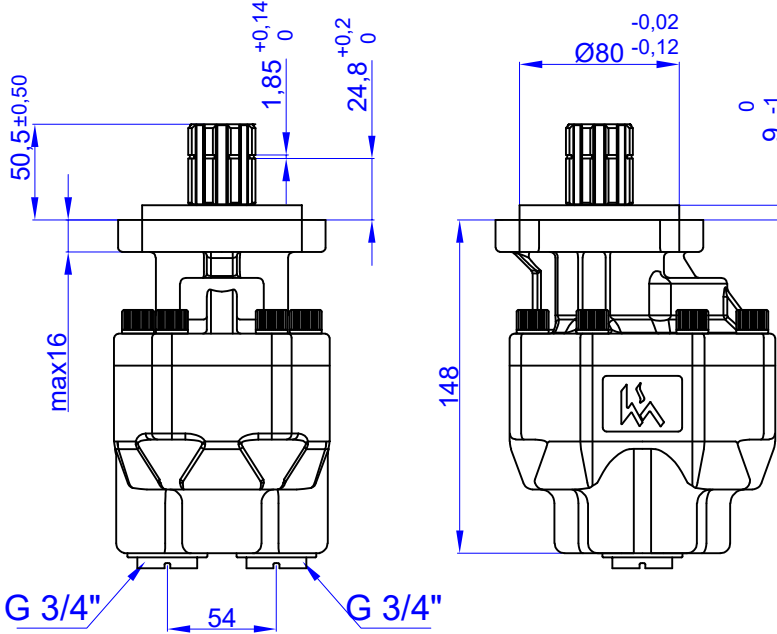

### TEKNİK BİLGİLER / TECHNICAL DATA

Specifications		
Displacement	25	cm <sup>3</sup> /rev
Max. Peak Pressure (P3)	250	bar
Max. Intermittent Pressure (P2) (for tipping applications)	240	bar
Max. Continuous Pressure (P1)	210	bar
Max. Speed at Intermittent Press.	2500	min <sup>-1</sup>
Min. Speed at Intermittent Press.	400	min <sup>-1</sup>
Max. Speed at Continuous Press.	1900	min <sup>-1</sup>
Oil Temperature Range	-40 ~ 80	°C
Inlet Pressure Range (suction side)	0,7 ~ 3	bar
Recommended Oil Viscosity Range	12 ~ 100	mm <sup>2</sup> /s (cSt)
Max. Starting Viscosity	750	mm <sup>2</sup> /s (cSt)
<b>Filtration :</b>		
-Working Pressure < 200 bar	25	µm
-Working Pressure > 200 bar	10	µm
<b>Connection :</b>		
Min. Suction Hose Bore Diameter	--	inch
Weight	8,3	kg
Rust prevent oil applied shaft area	protect 12 moths	

Power and Torque					
Pressure (Bar)	50	100	150	200	250
Torque (Nm)	22	44	66	88	111

Power (kW)					
rpm / Bar	50	100	150	200	250
500	1	2	4	5	6
1000	2	5	7	9	12
1500	4	7	11	14	18
2000	5	9	14	19	24
2500	6	12	18	24	30

rpm (n/min)	Flow (L/min)
500	12
1000	25
1500	37
2000	49
2500	61

### DİYAGRAMLAR / DIAGRAMS

#### Power-Pressure Graphic

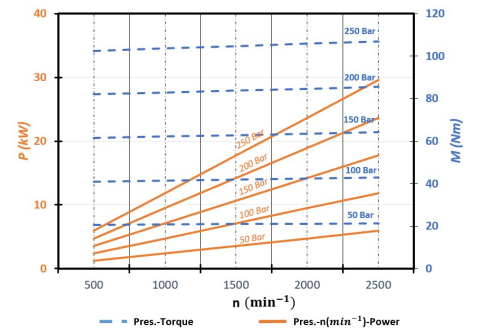

#### Flow-rpm Graphic

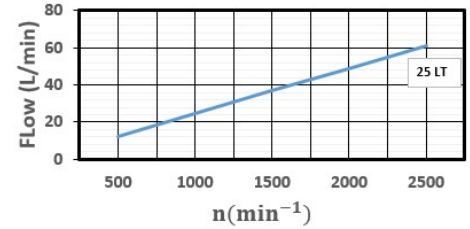

#### Torque-Pressure Graphic

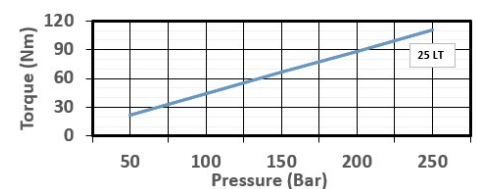

#### Pressure Definition

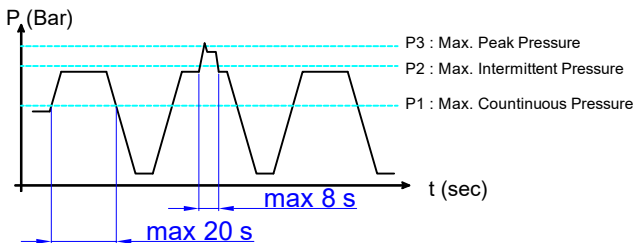

#### Hydraulic Pump Symbol

