



GALİPOĞLU®  
**HIDROMAS**

Phone : 90.332 239 08 52 (pbx)

Fax : 90.332 239 08 51

Mail : hidromas@hidromas.com

Address : Büyükkayacık Mah. Konya O.S.B. 3 Nolu Sk No:1/A 42250

SELÇUKLU / KONYA

TÜRKİYE

GHS 63-50-541 TTHS (L 850)

Product Code :

44202032

Reference No :

01-002

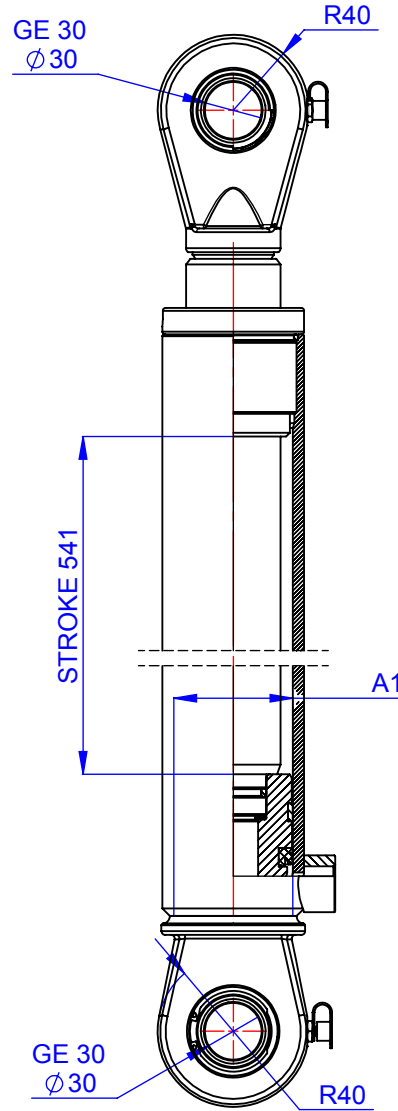
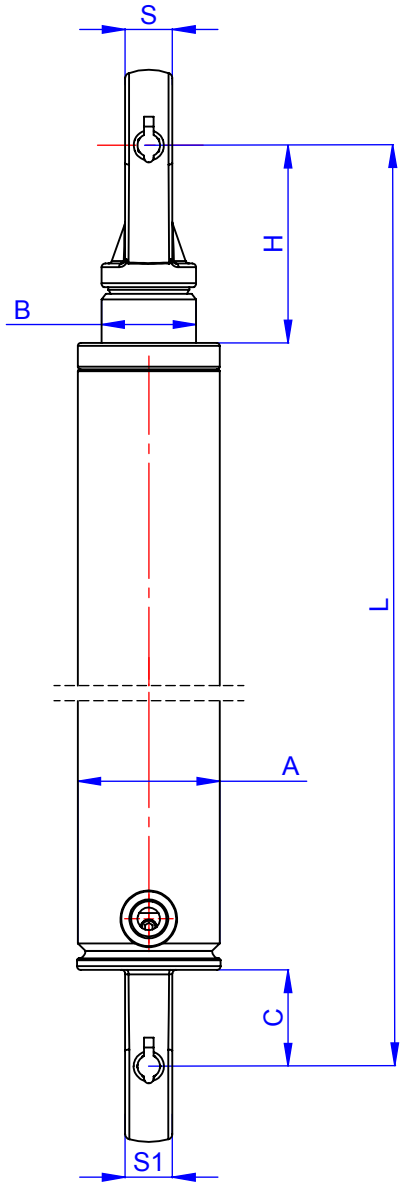

A :	75
A1 :	63
B :	50
C :	51
D :	
E :	
F :	
G :	
H :	105
I :	
J :	
K :	
L :	850
M :	
N :	
O :	
P :	
R :	
R1 :	
S :	25
S1 :	25
T :	
U :	
V :	
Y :	
Z :	

All sizes were given as mm

#### SPECIFICATIONS

- Stroke : 541
- Open Center : 1391
- Closed Center : 850
- Working pressure (Bar) : 170
- Max. working pressure (Bar): 200
- Thrust at 170 bar (Tons) : 5.3
- Pull force at 170 bar (Tons) :
- Working temperature (°C) : -23 °C / +80 °C
- Thrust volume (L) : 1.7
- Pull volume (L) :
- Weight of cylinder (Kg) : 20.97
- Hard chromed rods
- All cylinder tubes materials are st 52 cold down tubes

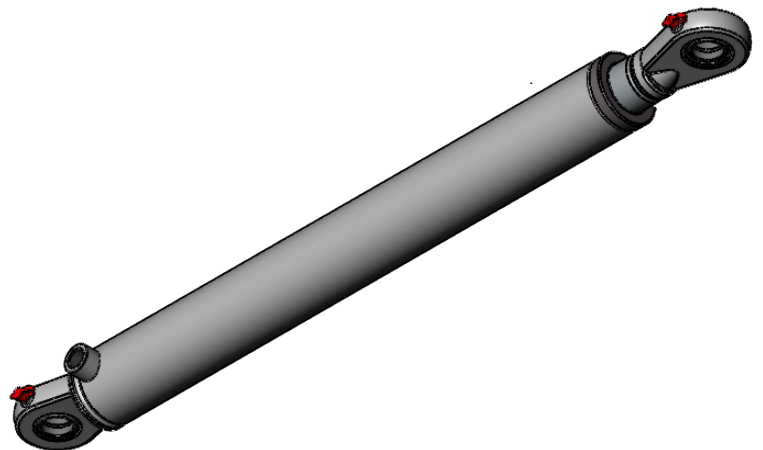

Standart Colour:Black RAL 9005