

105 cc BI-ROTATIONAL GEAR PUMP-ISO
DPA 35-105 ÇİFT DÖNÜŞLÜ DİŞLİ POMPA

Product Code / Ürün Kodu : PDCD3510510133
Ref. No : 0004

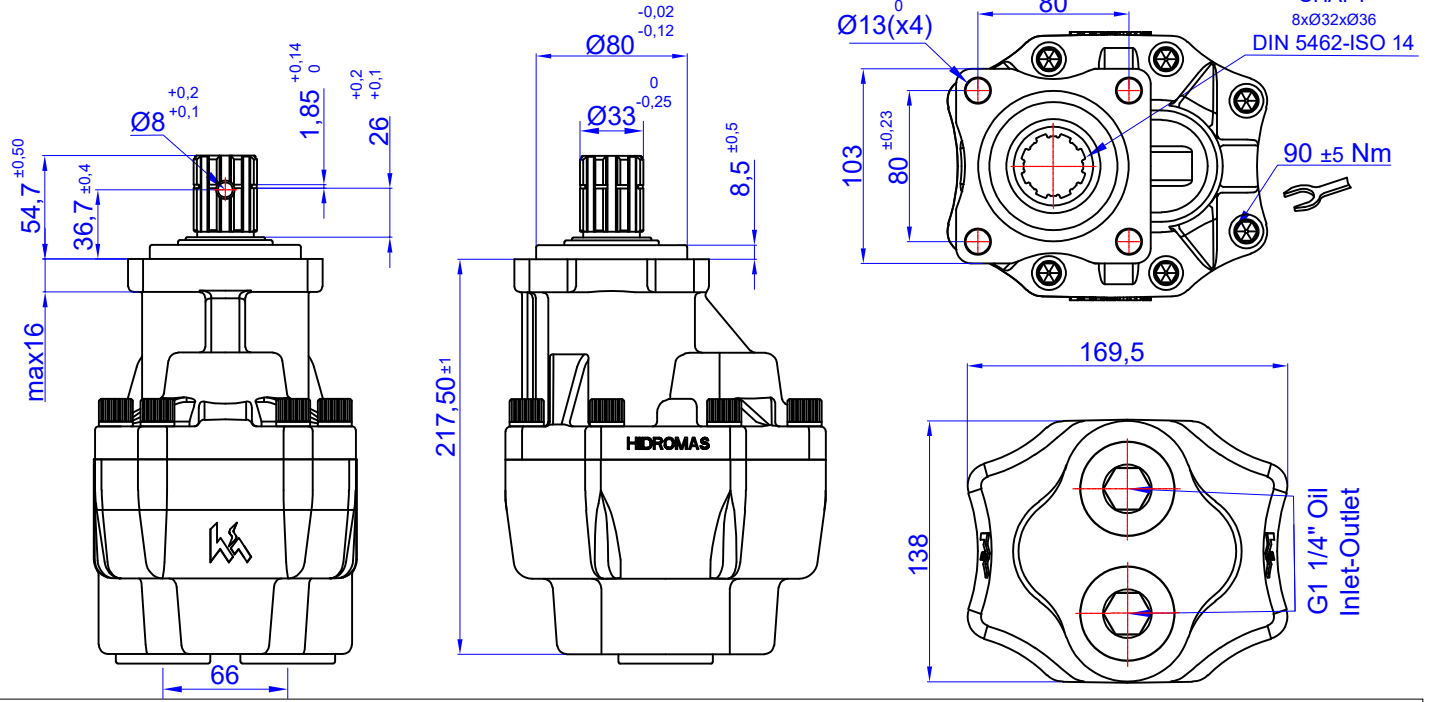

TEKNİK BİLGİLER / TECHNICAL DATA

Specifications

Displacement	105	cm ³ /rev
Max. Peak Pressure (P3)	255	bar
Max. Intermittent Pressure (P2) (for tipping applications)	240	bar
Max. Continuous Pressure (P1)	220	bar
Max. Speed at Intermittent Press.	1900	min ⁻¹
Min. Speed at Intermittent Press.	300	min ⁻¹
Max. Speed at Continuous Press.	1400	min ⁻¹
Oil Temperature Range	-40 ~ 80	°C
Inlet Pressure Range (suction side)	0,7 ~ 3	bar
Recommended Oil Viscosity Range	12 ~ 100	mm ² /s (cSt)
Max. Starting Viscosity	750	mm ² /s (cSt)
Filtration :		
-Working Pressure < 200 bar	25	µm
-Working Pressure > 200 bar	10	µm
Connection :		
Min. Suction Hose Bore Diameter	-	inch
Weight	19	kg
Rust prevent oil applied shaft area	protect 12 months	

Power and Torque					
Pressure (Bar)	50	100	150	200	255
Torque (Nm)	93	186	279	371	473

Power (kW)					
rpm / Bar	50	100	150	200	255
500	5	10	15	20	25
1000	10	20	30	40	51
1200	12	24	36	48	61
1400	14	28	42	56	71
1900	19	38	57	76	96

rpm (n/min)	Flow (L/min)
500	51
1000	103
1200	123
1400	144
1900	196

DİYAGRAMLAR / DIAGRAMS

Power-Pressure Graphic

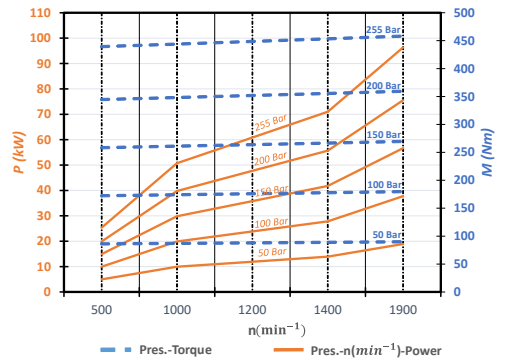

Flow-rpm Graphic

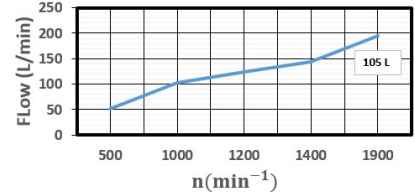

Torque-Pressure Graphic

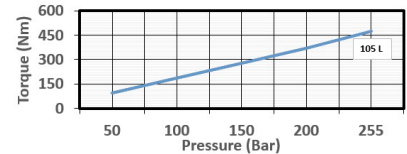

Pressure Definition

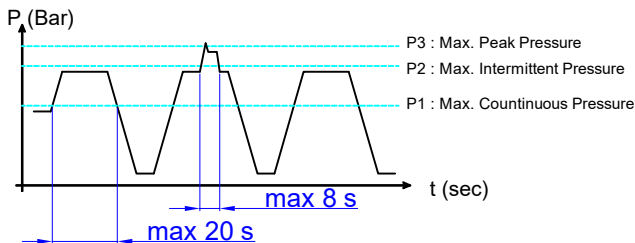

Hydraulic Pump Symbol

