

105 cc BI-ROTATIONAL GEAR PUMP DM-ISO  
DPA 35-105 ÇİFT DÖNÜŞLÜ (DM) DİŞLİ POMPA

Product Code / Ürün Kodu : PDCD3510540133  
Ref. No : 0001

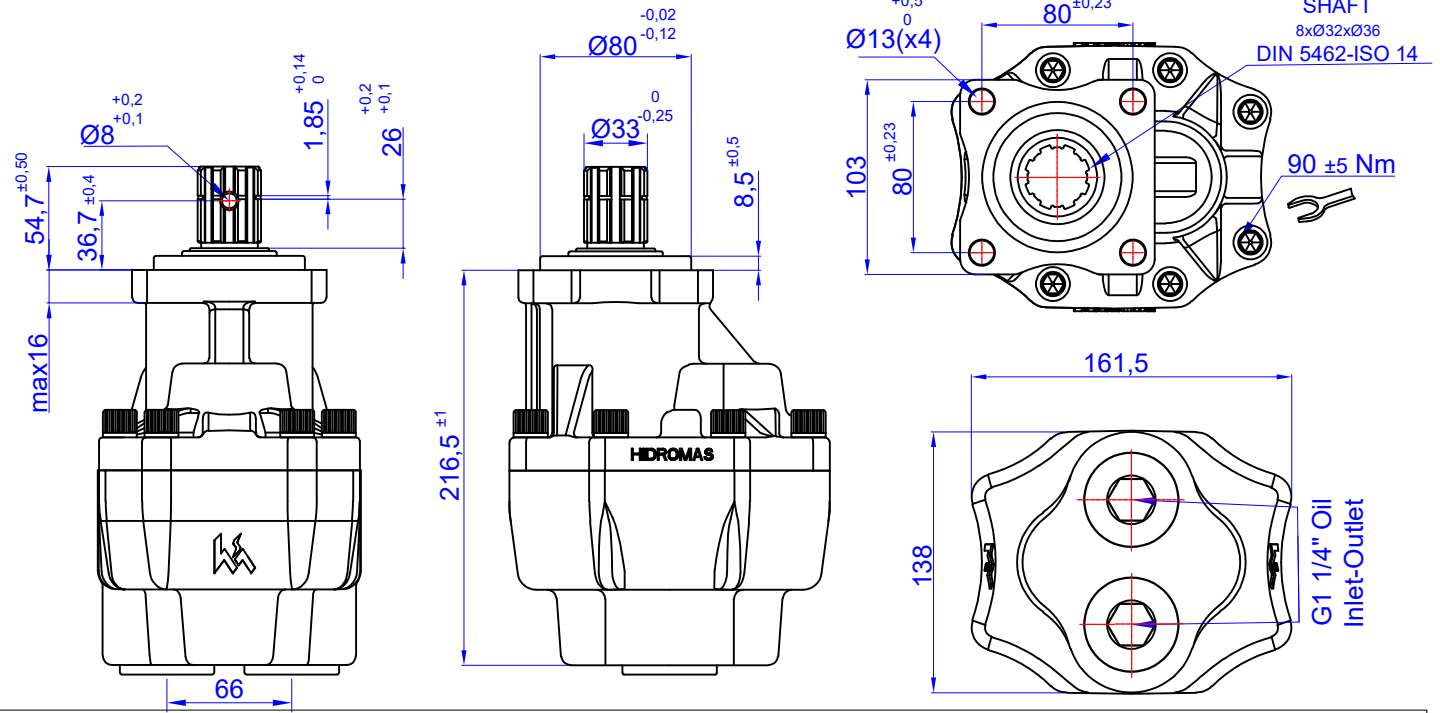

### TEKNİK BİLGİLER / TECHNICAL DATA

#### Specifications

Displacement	105	cm <sup>3</sup> /rev
Max. Peak Pressure (P3)	255	bar
Max. Intermittent Pressure (P2) (for tipping applications)	240	bar
Max. Continuous Pressure (P1)	220	bar
Max. Speed at Intermittent Press.	1900	min <sup>-1</sup>
Min. Speed at Intermittent Press.	300	min <sup>-1</sup>
Max. Speed at Continuous Press.	1400	min <sup>-1</sup>
Oil Temperature Range	-40 ~ 80	°C
Inlet Pressure Range (suction side)	0,7 ~ 3	bar
Recommended Oil Viscosity Range	12 ~ 100	mm <sup>2</sup> /s (cSt)
Max. Starting Viscosity	750	mm <sup>2</sup> /s (cSt)
<b>Filtration :</b>		
-Working Pressure < 200 bar	25	µm
-Working Pressure > 200 bar	10	µm
<b>Connection :</b>		
Min. Suction Hose Bore Diameter	--	inch
Weight	18	kg
Rust prevent oil applied shaft area	protect 12 moths	

#### Power and Torque

Pressure (Bar)	50	100	150	200	255
Torque (Nm)	93	186	279	371	473

#### Power (kW)

rpm / Bar	50	100	150	200	255
500	5	10	15	20	25
1000	10	20	30	40	51
1200	12	24	36	48	61
1400	14	28	42	56	71
1900	19	38	57	76	96

#### rpm (n/min) Flow (L/min)

rpm (n/min)	500	1000	1200	1400	1900
Flow (L/min)	51	103	123	144	196

### DİYAGRAMLAR / DIAGRAMS

#### Power-Pressure Graphic

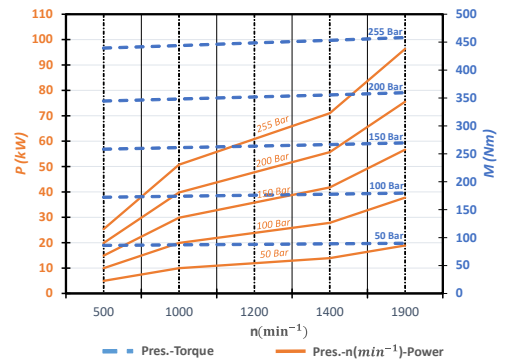

#### Flow-rpm Graphic

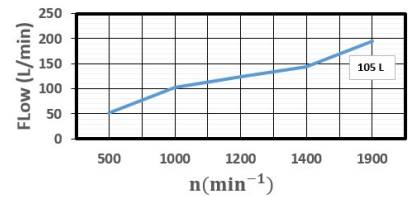

#### Torque-Pressure Graphic

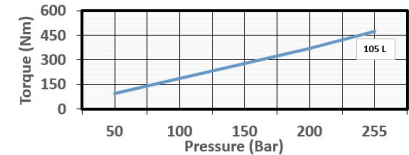

#### Pressure Definition

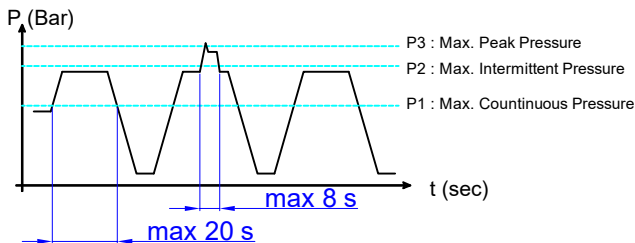

#### Hydraulic Pump Symbol

