

GHS 116 x 3 x 2760 A

Drawing No :43116327601

Reference No :01-001

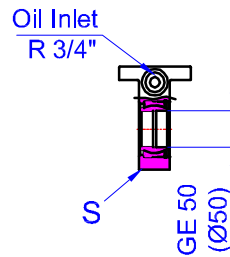
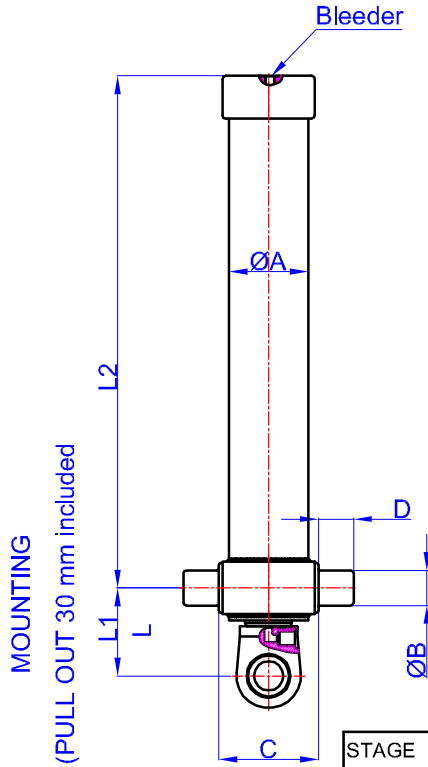

A	:	136	mm
B	:	60	mm
C	:	170	mm
D	:	60	mm
L	:	150	mm
*L1	:	180	mm
L2	:	1063	mm
S	:	42	mm

* Inc 30 mm pull out :
tolerance +20 -0
 Hard Chromed all stages
 Working Pressure : 170 Bar
 Max. Working Pressure : 190 Bar
 All Cylinder Materials are St
 52 Cold Drawn Tubes

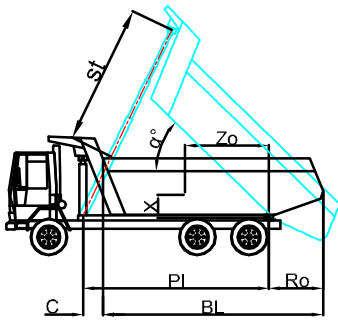

STAGE	1	2	3	4	5	6	7	8	TOTAL
EFFECTIVE DIAMETER (mm)	Ø116	Ø98	Ø80						
STROKE	920	920	920						2760
OIL DISPLACEMENT (L)	10,5	7,5	5						27
THRUST AT 170 BAR (TONS)	18	12	8						

BL (body length)	200	3400	600	200	3300	600	200	3200	600
Ro (rear overhang)	46	49	52	47	51	54	49	52	57
Ycog (vert. pos. centre of gravity)	400	22	26	32	23	27	34	24	28
PI (Pivot lengt)	700	26	33	43	27	35	44	29	38
α° = st x 60 / PI	1000	33	40	48	34	41	49	36	42
st	2606	2613	2600	2585	2635	2610	2613	2600	2660

Weight : 91 Kg

Drawing No :43116327601-01-001