



GALİPOĞLU  
**HIDROMAS**

Phone : +90 332 239 08 52 (pbx)  
 Fax : +90 332 239 08 51  
 Mail : hidromas@hidromas.com  
 Address : Büyükkayacık Mah. Konya O.S.B. 3 Nolu Sk No:1/A 42250  
 SELÇUKLU / KONYA  
 TÜRKİYE

**GHS 220 x 5 x 5750 C**

Stock Code : 43220557503

Reference No : 01-001

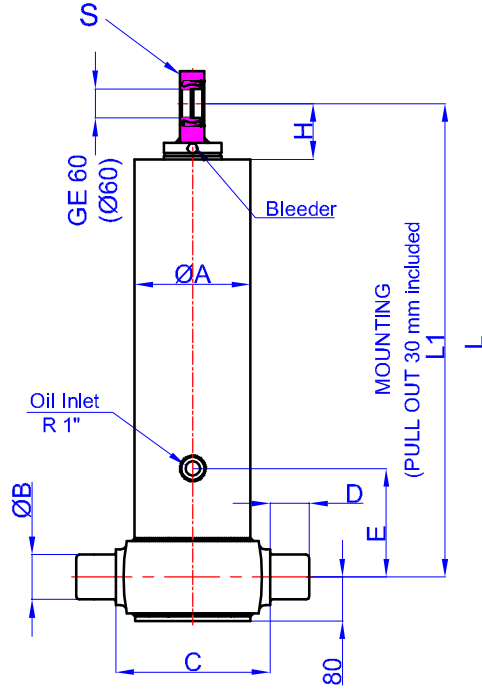

- A : 246 mm
- B : 70 mm
- C : 290 mm
- D : 70 mm
- E : 350 mm
- H : 97,5 mm
- L : 1438 mm
- \*L1 : 1468 mm
- S : 50 mm

\* Inc 30 mm pull out :  
 tolerance +20 -0  
 Hard Chromed all stages  
 Working Pressure : 170 Bar  
 Max. Working Pressure : 190 Bar  
 All Cylinder Materials are St  
 52 Cold Drawn Tubes

| STAGE                    | 1    | 2    | 3    | 4      | 5    | 6 | 7 | 8 | TOTAL |
|--------------------------|------|------|------|--------|------|---|---|---|-------|
| EFFECTIVE DIAMETER (mm)  | Ø220 | Ø197 | Ø175 | Ø154,5 | Ø135 |   |   |   |       |
| STROKE                   | 1150 | 1150 | 1150 | 1150   | 1150 |   |   |   | 5750  |
| OIL DISPLACEMENT (L)     | 46,6 | 37,6 | 29,8 | 23,4   | 18   |   |   |   | 169   |
| THRUST AT 170 BAR (TONS) | 64   | 51,3 | 40,5 | 31,7   | 24,1 |   |   |   |       |

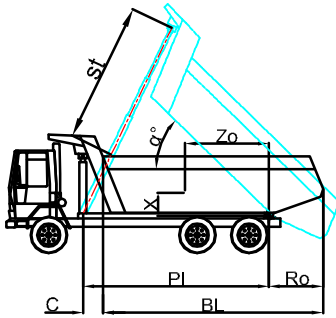

BL (body length)  
 Ro (rear overhang)  
 Ycog (vert. pos. centre of gravity)  
 PI (Pivot length)  
 $\alpha^\circ = \text{st} \times 60 / \text{PI}$

|        | 7400 |      |      | 7200 |      |      | 7000 |      |      |
|--------|------|------|------|------|------|------|------|------|------|
| BL     | 200  | 500  | 800  | 200  | 500  | 800  | 200  | 500  | 800  |
| Ro     | 45   | 47   | 49   | 46   | 48   | 51   | 48   | 50   | 53   |
| Ycog   | 69   | 75   | 83   | 70   | 77   | 86   | 72   | 80   | 90   |
| PI     | 74   | 82   | 93   | 76   | 85   | 98   | 79   | 89   | 104  |
| st     | 81   | 91   | 106  | 83   | 95   | 113  | 87   | 101  | 118  |
| Weight | 5550 | 5561 | 5553 | 5520 | 5520 | 5610 | 5600 | 5583 | 5653 |

Weight : 351,3 Kg

Drawing No : 43220557503-15-001